

Rectifier Unit

SAV 876.06

For general purpose and clamping magnets

Use:

For power supply of general purpose and clamping magnets.

For electro magnets as low-cost alternative for polarity-reversing controls in case holding force control and demagnetizing are not required.

Execution:

With silicon bridge rectifier and transformer with insulated separate windings.

Version in switching box for wall assembly (S) protection class IP54. Also available in build-in version (E) protection class IP00.

In standard version switching by mains supply. Optional available with control element in box door (B). The dimensions for build-in version differ slightly from table.

Ambient temp. max: 35 °C

Power supply, switchable: 230 V AC / 400 V AC

Frequency: 50 / 60 Hz

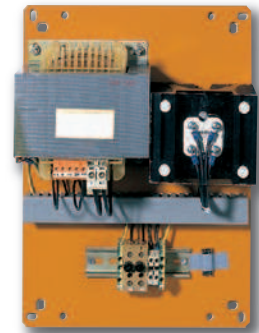

build-in version (E)

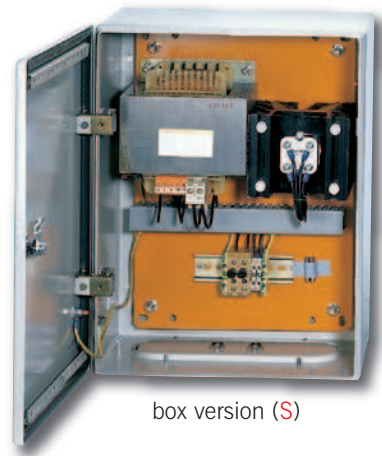

box version (S)

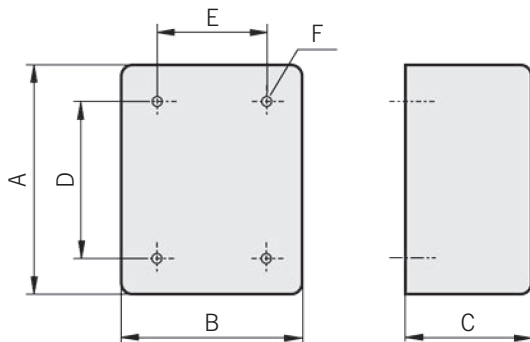

Magnetic nom. voltage DC in V	Max. magnet current in A	Mains voltage in AC	Max. power at the magnet DC in W	Weight in kg	Dimensions in mm					
					A	B	C	D	E	F
24	4.5	230 / 400	108	4.0	210	140	144	150	120	9
24	7	230 / 400	168	9.0	318	140	218	187	194	9
24	15	230 / 400	360	17.0	418	210	318	287	294	9
24	30	230 / 400	720	34.0	618	210	418	487	394	9
110	1.5	230 / 400	165	9.0	318	140	218	187	194	9
110	6	230 / 400	660	22.0	418	210	318	287	294	9
110	16	230 / 400	1760	34.0	618	210	418	487	394	9
110	30	230 / 400	3300	65.0	818	260	618	687	594	9

Ordering example: Rectifier Unit SAV 876.06 - E / 110 / 30 / 230

Ordering key: Name SAV No. - Box. / Nom. Magnet voltage / Max. current / Mains voltage