

Electro Magnetic Circular Chuck

SAV 244.40

With radial pole arrangement

These circular electro magnets are notable for their very high holding force. Radial T-slots can be provided in the pole plates for added flexibility.

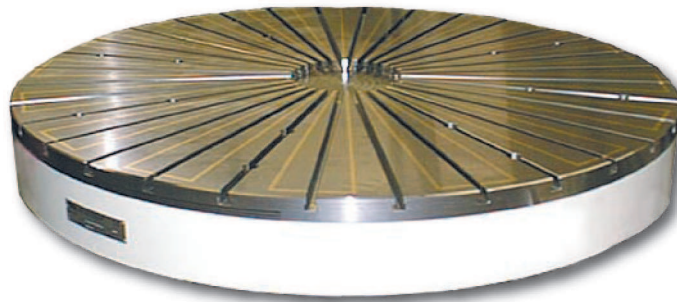

Use:

Grinding of circular and ring-shaped workpieces on carousel internal and external grinding machines. Also suitable for turning with form and position tolerances of 0.01 to 0.02 mm.

- equal pole pitch within circle range; therefore very suitable for circular and ring shaped workpieces

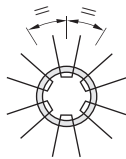

- for ring-shaped workpieces the minimum height is 35% of the pole pitch at the given circle segment

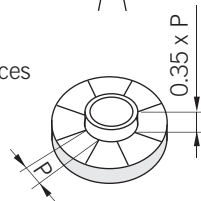

- also for thin rings

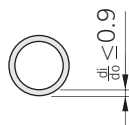

Nominal holding force:

120 N/cm²,
adjustable by control unit with encoded switch

Nominal operating voltage:

24 V DC up to 90 W
110 V DC all sizes

Features:

- solid designed pole plate
- radial pole arrangement, especially suitable for the use of pole raisers. This is absolutely essential for the runout of the tool or the grinding wheel at three side operation. Therefore available with T-slots (T) according DIN 650-10H10 on request.
- pole plate wearing limit 8 mm
- sealed to IP 65
- suitable for continuous (100%) operation
- for use with control unit type 876.10 (see chapter 04)
- available with adapter flange on request (SAV 248.90 to 248.94, see chapter 01)

Scope of supply:

- Lifting bolts for transportation on larger models.
- T-slots and pole extensions not included as standard.
- Terminals for electrical connection in middle of back side in standard execution.
- Optional with integrated slip ring body for the bigger diameters.

Electro Magnetic Circular Chuck

SAV 244.40

With radial pole arrangement

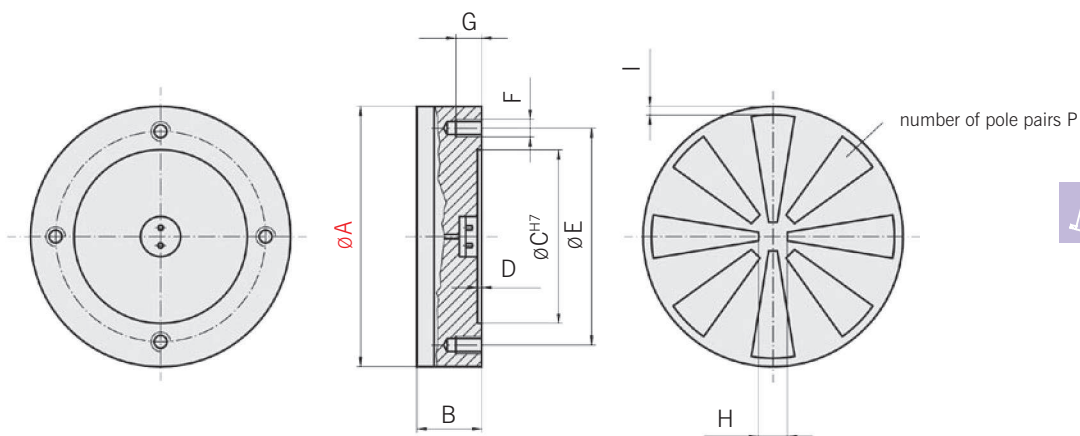

| Dimensions in mm | | | | | | | | | | Power in W | Weight in kg | |
|------------------|------------------|-----|---|-------------------------|----------|----|-----|-----|----|---------------|-----------------|------|
| A | B* \varnothing | C | D | E | F | G | H | I | P | | | |
| 100 | 80 | 60 | 3 | 80 | M8 (3x) | 12 | 30 | 10 | 3 | 16 | 4 | |
| 150 | 80 | 90 | 3 | 120 | M10 (3x) | 14 | 30 | 10 | 3 | 30 | 9 | |
| 200 | 90 | 110 | 3 | 140 | M10 (4x) | 14 | 40 | 10 | 4 | 48 | 18 | |
| 250 | 90 | 140 | 3 | 170 | M12 (4x) | 16 | 50 | 10 | 4 | 66 | 29 | |
| 300 | 90 | 160 | 3 | 190 | M12 (4x) | 16 | 60 | 10 | 6 | 90 | 42 | |
| 400 | 90 | 210 | 4 | 250 | M12 (6x) | 16 | 70 | 15 | 6 | 150 | 76 | |
| 500 | 90 | 280 | 4 | 320 | M12 (6x) | 16 | 100 | 15 | 8 | 190 | 120 | |
| 600 | 100 | 350 | 4 | 390 | M16 (6x) | 18 | 100 | 15 | 8 | 265 | 195 | |
| 700 | 100 | 400 | 4 | 450 | M16 (6x) | 18 | 120 | 15 | 8 | 350 | 265 | |
| 800 | 100 | 450 | 4 | 500 | M16 (6x) | 18 | 150 | 18 | 12 | 440 | 365 | |
| 1000 | 100 | 550 | 4 | 620 | M16 (8x) | 18 | 200 | 18 | 12 | 660 | 550 | |
| 1200 | 125 | | | Rear detail as required | | | | 300 | 25 | 18 | 960 | 990 |
| 1400 | 125 | | | Rear detail as required | | | | 300 | 25 | 18 | 1100 | 1350 |
| 1500 | 125 | | | Rear detail as required | | | | 300 | 25 | 18 | 1440 | 1550 |
| 1600 | 125 | | | Rear detail as required | | | | 300 | 25 | 18 | 1630 | 1760 |

Other sizes up to diameter A = 3100 mm available on request. Please refer to SAV 876.03 to SAV 876.10 (see chapter 04), for details regarding suitable control units, based on the power rating. Bigger sizes can be constructed out of several segments.

*in execution with T-slots the height increases with 10 mm

Ordering example: **Electro Magnetic Circular Chuck SAV 244.40 - 800 - T - 110 V**

Ordering key: Name SAV - No. - A - Execution - Operating voltage