

Electro Magnetic Chuck

SAV 243.41

With fine longitudinal pole pitch $P = 4 \text{ mm}$

Electromagnetic system with very narrow pole pitch. Especially suitable for thin workpieces. Workpiece positioning in cross direction of the chuck.

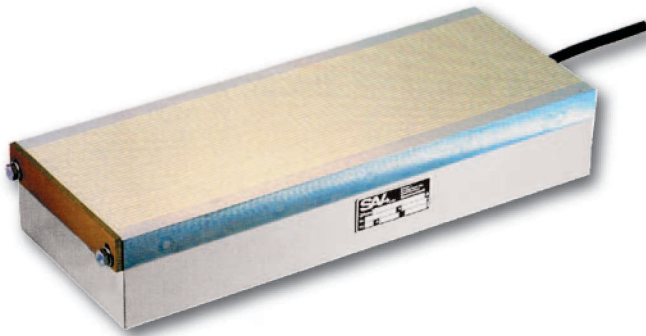

Use:

Clamping of thin, plate shaped workpieces with form and positional tolerances of 0.01 to 0.02 mm.

- for workpiece positioning cross to pole pitch

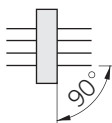

- for thin workpieces of min. 2 mm thick



- for flat workpieces with min. dimensions 40 x 40 mm

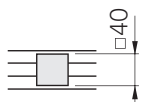

Nominal holding force:

100 N/cm²,
adjustable with control unit
with encoded switch

Nominal operating voltage:

24 V DC up to 118 W
110 V DC for all sizes

Features:

- especially fine, uninterrupted longitudinal pole pitch, 3 mm steel and 1 mm brass
- glued lamination with additional pull anchors cross to lamination
- fine grid pole plate to body connection
- 8 mm pole plate wearing limit
- low magnetic field height
- mounting slots in both short faces
- through holes for mounting in sizes over 1000 mm length on specification
- robust and waterproof
- sealed to IP 65
- suitable for continuous (100%) operation
- for use with control unit type SAV 876.10 (chapter 04)

Auxiliary equipment:

- sidestop rail on short and long face
- connecting cable, 3 m, on the right-hand, short face
- lifting bolts on larger models

Electro Magnetic Chuck

SAV 243.41

With fine longitudinal pole pitch $P = 4 \text{ mm}$

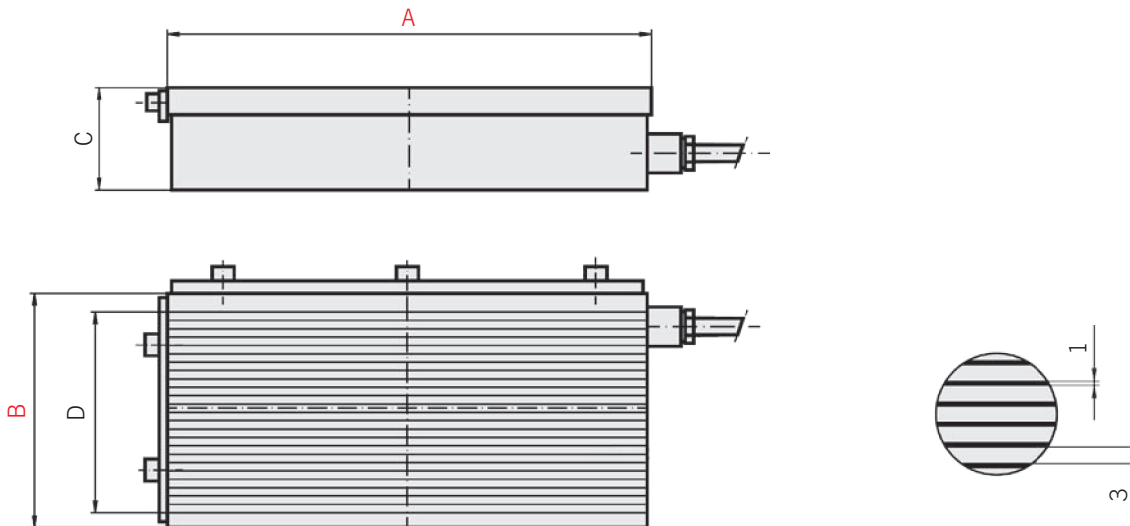

Dimensions in mm				Power rating in W	Weight in kg
A	B	C ₁	D		
200	100	87	53	30	13.0
300	100	87	53	45	20.0
300	150	87	101	65	29.0
400	150	87	101	90	39.0
450	175	87	125	106	51.0
400	200	87	149	118	52.0
500	200	87	149	140	64.0
600	200	87	149	162	77.0
800	200	87	149	206	103.0
500	250	87	197	150	81.0
600	250	87	197	180	97.0
800	250	87	197	233	129.0
500	300	87	253	175	97.0
600	300	87	253	206	116.0
800	300	87	253	268	155.0
1000	300	87	253	330	193.0

Dimensions in mm				Power rating in W	Weight in kg
A	B	C ₁	D		
600	350	87	301	235	135.0
800	350	87	301	305	180.0
1000	350	87	301	375	225.0
600	400	87	349	265	155.0
700	400	87	349	305	180.0
800	400	87	349	345	206.0
1000	400	87	349	425	258.0
1200	400	87	349	510	310.0
800	500	87	453	420	257.0
1000	500	87	453	510	322.0
1200	500	87	453	612	386.0

Other sizes and operating voltages available on request. Larger clamping surfaces can be made by flush mounting several units.

Please refer to SAV 876.10 to SAV 876.06, for details regarding suitable control units, based on the power rating

Ordering example: **Electro Magnetic Chuck SAV 243.41 - 300 x 150 - 110 V**
 Ordering key: Name SAV - No. - A x B - Operating voltage